

# COPYRIGHT:

DEUTSCH

DIESE DRUCKSCHRIFT UND ALLE IHRE BESTANDTEILE IST URHEBERRECHTLICH GESCHÜTZT.

ABBILDUNGEN, GRAFISCHE DARSTELLUNGEN, TEXTE ODER DIE DRUCKSCHRIFT INSGESAMT ODER IN TEILEN DÜRFEN NICHT OHNE VORHERIGE SCHRIFTLICHE GENEHMIGUNG NACHGEDRUCKT ODER SONST REPRODUZIERT WERDEN (Z. B. AUF CD-ROM ODER IM INTERNET).

WENN SIE DIESE PDF-DATEI FÜR IHREN PERSÖNLICHEN GEBRAUCH VON UNSERER INTERNET-SEITE KOPIERT HABEN, MÖCHTEN WIR DARAUF HINWEISEN, DASS ALLE DORT ZUR VERFÜGUNG GESTELLTEN DATEIEN OHNE JEDEN WEITERN HINWEIS AUF DEN NEUESTEN TECHNISCHEN STAND GEBRACHT WERDEN. DIE ÄNDERUNG VON TECHNISCHEN DATEN UND LIEFERUMFANG IST DAHER VORBEHALTEN.

# COPYRIGHT:

## ENGLISH

ALL ARTWORK, PICTURES AND TEXTS ARE COVERED BY OUR COPY-RIGHT.

THEY MUST NOT BE COPIED FOR REPRODUCTION (E.G. ON CD-ROM DISKS OR INTERNET-SITES) OR USED IN THEIR ENTIRE FORM OR IN EXCERPTS WITHOUT OUR PREVIOUS WRITTEN AGREEMENT.

IF YOU ARE DOWNLOADING PDF-FILES FROM OUR INTERNET HOME-PAGE FOR YOUR PERSONAL USE, MAKE SURE TO CHECK FOR UPDATED VERSIONS.

WE CANNOT TAKE ANY LIABILITY WHATSOEVER FOR DOWNLOADED FILES, AS TECHNICAL DATA ARE SUBJECT TO CHANGE WITHOUT NOTICE.

# ARRI



MB-16



4"x4"  
ProductionMatte Box MB-16

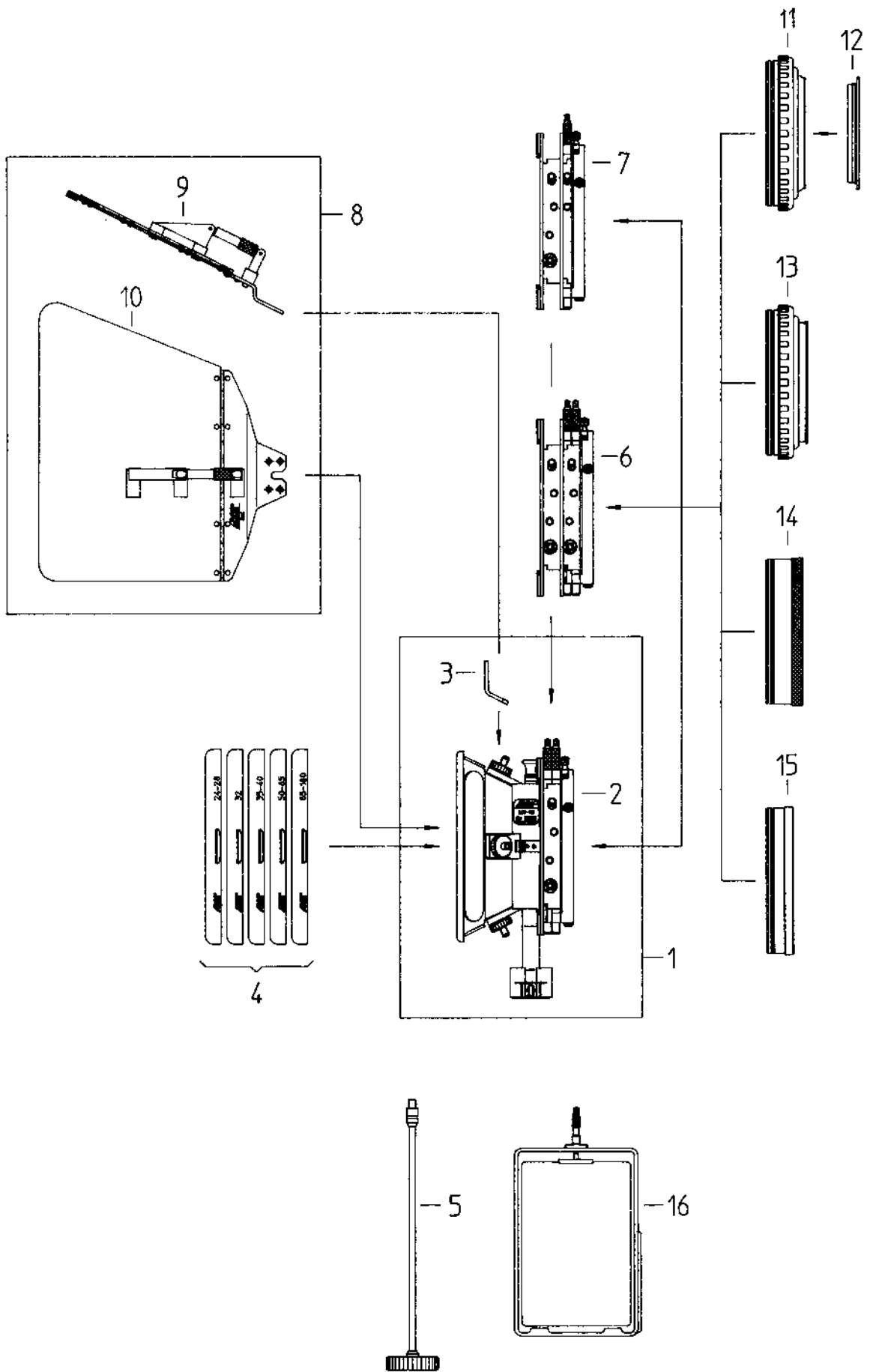

The 4"x4" Production Matte Box MB-16 System

Item	Ident-No.	Description
1	K2.44472.0	4"x4" Production matte box MB-16 (for support rods 19 mm dia.) with 2 x filter stage and french flag holder
	K2.44472.A	4"x4" Production matte box MB-16 (for support rods 15 mm dia.) with 2 x filter stage and french flag holder
2	K4.41709.0	2 x filter stage for two 4"x4" push-through filters, individually rotatable (incl. in item 1)
3	K5.41763.0	French flag holder (incl. in item 1)
4	K2.41699.0	Set of masks for 35 mm 24-180 mm lenses
	K2.41701.0	Set of masks for 16 mm 12-180 mm lenses
5	K2.34890.0	Flexible drive shaft for graduated filters
6	K2.41596.0	4 x filter stage for four 4"x4" push-through filters , (two rotatable in pairs, two individually)
7	K2.45810.0	3 x filter stage for three 4"x4" push-through filters, (two rotatable in pairs, one individually)
8	K0.59985.0	Light trap set (top/bottom K2.41703.0, lateral K2.41705.0/pair)
9	K2.41703.0	Light trap top/bottom (incl. in item 8)
10	K2.41705.0	Light trap lateral/pair (incl. in item 8)
11	K2.49109.0	4 1/2" filter ring with retaining ring 87 mm dia. for Zeiss Vario-Sonnar T2/10-100 II and T2.2/11-110
12	K2.47226.0	Insert ring 80 mm dia. for prime lenses and Zeiss Vario-Sonnar T2/10-100 (item 11 necessary)
13	K2.49102.0	4 1/2" filter ring for Canon 7-56 and 8-64 and 11.5-138
14	K2.32903.0	4 1/2" filter ring for Zeiss T3/300, Vario-Sonnar T3/10-100 and Cooke 9-50/10.4-52
15	K2.32911.0	Anti-reflection ring for Zeiss T3/300, Vario-Sonnar T3/10-100 and Cooke 9-50/10.4-52
16	K2.32220.0	4"x5.65" filter frame
	K2.41897.0	4"x5.65" filter frame, toothed
	K2.34980.0	4"x6" filter frame
	K2.41697.0	4"x6" filter frame, toothed
	K4.47070.0	4"x4" filter frame (spare)
	K2.34577.0	3"x3" filter frame
	K2.43474.0	Case for production matte box and accessories (variable dividers)

## 4" x 4" Production Matte Box MB-16

The standard equipment of the 4" x 4" production matte box MB-16 includes a 2x filter stage for two rotatable 4" x 4" push-through filters. One of the filter frames is toothed for operation by turning knob or flexible shaft.

At the rear of the filter stage there is a receptacle for 4 1/2" filter rings and for an anti-reflection ring. The 2x filter stage can be interchanged against other filter stages. For easy lens changing the matte box swings open 90°. A

french flag holder is included with the matte box.

Technical data:

Min. focal length 35 mm lenses	16 mm
Min. focal length 16 mm lenses	8 mm
Max. number of filters (with 4x filter stage)	four filters + one 4 1/2" round filter
Dimensions	240 x 230 x 103 mm (9.4 x 9.0 x 4.0 in)
Weight	ca. 950 g (2.1 lbs)



ARNOLD & RICHTER CINE TECHNIK

TÜRKENSTR. 89 • D-80799 MÜNCHEN • TEL. (089) 3809-0  
FAX (089) 3809-1244 • <http://www.arri.com>